

# Auto Mold System Specification (ASM)

REV A

## 1. Standard

### 1-1 System standard

- Model : ASM IDEALmold R2R(1chases mold)

ITEM	Quantity	Note
System	1 set	80 ton press
Mid-plate	1 set	
Top chase /bottom chase	1 set	
PRP	1 set	

- Remarks: Mold chase can compensate substrate thickness +/- 0.06mm

### 1-2 System configurations

- 1) Machine time: 28-30 sec
- 2) LCD monitor: 12.1 Inch Touch Screen
- 3) Clamp pressure: 80Ton max  
(+/- 1% full scale around 0.8 ton)
- 4) Transfer pressure: 3 Ton Max (+/- 1% full scale around 0.03 ton)  
Set point = within Spec. actual is depending on tolerance spring compensation.
- 5) Mold temperature & pre-heater: (+/-5 degree C)

## **2. System**

### **2-1 General specification**

- . MTBA: 120 min.
- . Machine Time: 28-30 sec. (exclude process delay)
- . Clamp pressure: set +/- 5%
- . Transfer pressure: set +/- 5%
- . Mold Temp.: set +/- 5°C
- . Conversion Time: Max. 10 min. (\* for middle plate conversion only)

### **2-2 Film Loader system**

- 1) Reel to reel feeding system which is enable to expend 70mm width  
(With optional conversion kit)
- 2) Full automation and easy wheel loading feature
- 3) Vacuum cleaning for Protection from EMC particle
- 4) Detect function of presence of film
- 5) Tape orientation detection

### **2-3 EMC Loader system**

- 1) Full automatic EMC loading system
- 2) EMC chamber temperature control
- 3) EMC loading capacity: (~5 kg)
- 5) Automatic EMC pellet expiry reject function
- 6) EMC powder self-cleaning system
- 7) EMC pellet detect function (Size, Broken pellet)

### **2-4 Press/Mold part**

- 1) PGS Molding Technology
- 2) Vision inspection system to detect tape mis-load
- 3) Working pressure of transfer/clamp displayed and checked.
- 4) Film thickness compensation function
- 5) Mold chase total length= (350mm max, 2 reels)
- 6) Flexible plunger pitch
- 7) Material: ASP23, SST403
- 7) Pressure
  - Clamp: 80 tons max
  - Transfer: 3 tons max
- 10) Cycle time
  - Machine cycle time: 28-30 sec (exclude process delay)

- Transfer time: process dependent
- 11) Max Mold open size
- Top chase: day-light height 180mm
  - Bottom chase: day-light height 180mm
- 12) Cull discharged inside the equipment inside.

### **2-5 Communications**

- 1) Communication with host (LAN) (Optional)
- 2) Compatible with Bar code system (Optional)

### **2-6 HMI Program (Soft ware)**

- 1) Windows XP
- 2) Programmable parameter and Parameter display system
- 3) Parameter/data filing system (Save, delete, Open etc.)

### **3. Utility**

VOLTAGE INPUT	: THREE PHASE, MULTI INPUT VOLTAGE
CAPACITY	: 440/415/380/220/208
FREQUENCY	: 50/60 Hz
CONSUMPTION	: 10 Kw (PEAK 20 Kw)
AIR PRESSURE	: 5-7 Bar
AIR CONSUMPTION	: 500 NL/Min
WEIGHT	: 4 TON (APPROXIMATED)
EXHAUST	: 300 CUBIC METRES/ Hr

# IDEALmold R2R OVERALL DIMENSION

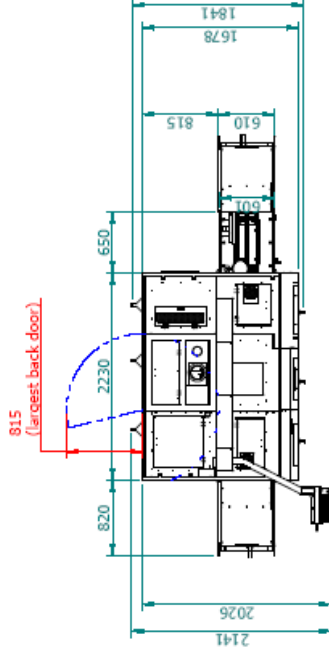

- MANUFACTURER : ASM TECHNOLOGY SINGAPORE
- ADDRESS : 2 YISHUN AVE 7, SINGAPORE 768924
- TELEPHONE NO : (65)-67526311
- MODEL : IDEALmold R2R AUTOMOLDING SYSTEM
- SERIAL NO : \_\_\_\_\_
- MANUFACTURE DATE : \_\_\_\_\_
- VOLTAGE INPUT : THREE PHASE, MULTI INPUT VOLTAGE
- CAPACITY : 440/415/380/220/208
- FREQUENCY : 50/60 HZ
- CONSUMPTION : 10 Kw (PEAK 20 Kw)
- AIR PRESSURE : 5-7 Bar
- AIR CONSUMPTION : 500 NL/Min
- WEIGHT : 4 TON (APPROXIMATED)
- EXHAUST : 300 CUBIC METER/ Hr

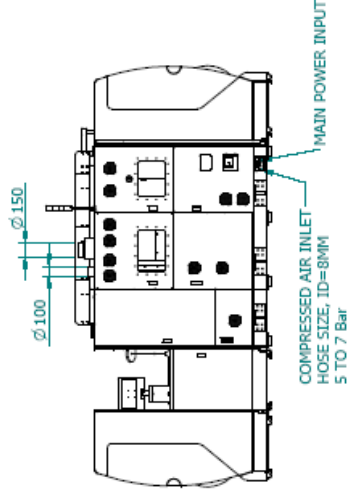
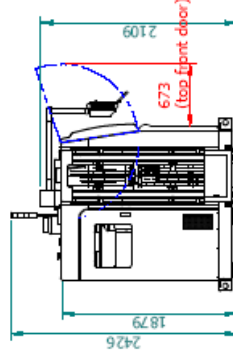
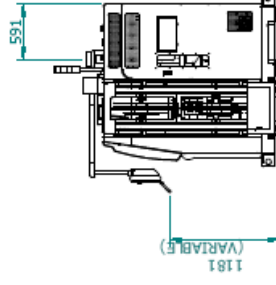
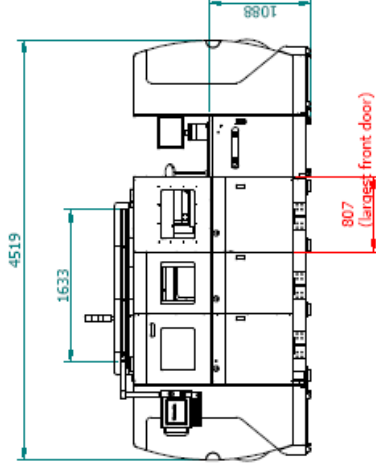

THIS DRAWING CONTAINS PROPRIETARY INFORMATION AND IS NOT TO BE USED OR REPRODUCED WITHOUT PERMISSION OF ASM

DO NOT SCALE  
 UNLESS OTHERWISE SPECIFIED  
 ALL DIM ARE IN  
 ALL RESISTORS ARE IN Ω  
 ALL CAPACITORS ARE IN μ F  
 TOLERANCES:  
 ISO STANDARD

4±

✓

DOWN BY : FIRST USED ON  
 INCURRED BY :  
 CHECKED BY :  
 ORIGINATOR :

ASM Technology Singapore

DESCRIPTION

SHEET : OF :  
 FILE :  
 DWG FILE :  
 SIZE : A3  
 PART NO. :

D.REV

P.REV